

## NOTICE:



EYE PROTECTION  
REQUIRED



GLOVES  
RECOMMENDED

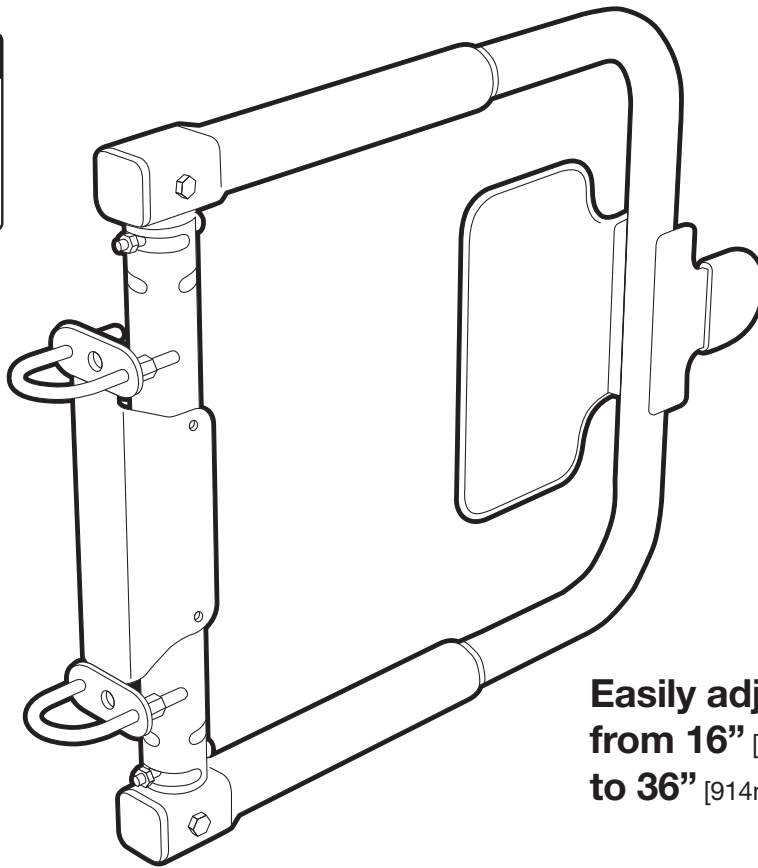

**Easily adjusts  
from 16" [406mm]  
to 36" [914mm] wide**

## IMPORTANT NOTES AND SPECIFICATIONS



Read carefully and understand all instructions before starting installation. Adhere to all instructions in manual.  
**FAILURE TO FOLLOW ALL INSTRUCTIONS MAY RESULT IN SERIOUS PERSONAL INJURY OR DEATH**

Prior to installation, ensure that mounting surface is adequate to support equipment and opening size is appropriate.

Equipment should not be altered or modified from its original design without consultation with the manufacturer.

Equipment which is damaged or becomes damaged during use, handling, or shipping should be set aside and not used.

Do not use impact wrenches to tighten. Doing so may cause damage to the equipment and its safe operation.



**WARNING!:** Keep hands away from potential pinch points and moving parts during operation.



**WARNING!:** Equipment must be installed so that it opens away from hole, ladder, stair or other fall hazard.  
**FAILURE TO DO SO MAY RESULT IN SERIOUS PERSONAL INJURY OR DEATH**

This product and/or it's components may be covered by one or more patents. For more information, go to [www.saferack.com/patents](http://www.saferack.com/patents)



**WARNING!:** This product can expose you to chemicals including cadmium, which is known to the State of California to cause cancer, and/or birth defect or other reproductive harm.

For more information, go to [www.p65warnings.ca.gov](http://www.p65warnings.ca.gov)



Contact our Customer Service team for help.

Call: **888-663-0015** (toll free)

Visit: **[www.yellowgate.com](http://www.yellowgate.com)**

**Scan QR** code to view a video of YellowGate assembly

# INTRODUCTION

YellowGate's 16"(406mm) to 36"(914mm) of adjustability, field reversible swing direction and universal mounting system protects every passageway, each gate is field adjustable for both length and swing direction. The universal mounting system mounts to angle iron, round pipe or square tube with no additional parts to order.

The malbec tensioner eliminates the need for a swing gate's most common failure point, the spring. The patent pending system provides field adjustable tension and maintenance free closure, every time.

|   |                            |   |                 |
|---|----------------------------|---|-----------------|
| <b>SYSTEM DESIGN</b><br><b>OSHA Regulation:</b> | Swing Gate should be used: | Swing Gate should meet design requirements: |                 |
|   | 1910.28 (b) (3) (iv)       | 1910.29 (b) (i)                             | 1910.29 (b) (5) |
|   | 1910.29 (b) (13) (i)       | 1910.29 (b) (2) (i)                         | 1910.29 (b) (6) |
|   |                            | 1910.29 (b) (2) (iv)                        | 1910.29 (b) (7) |
|   |                            | 1910.29 (b) (3)                             | 1910.29 (b) (9) |
|   |                            | 1910.29 (b) (4)                             |                 |

## TOOLS NEEDED FOR INSTALLATION

**NOTE:** NO POWER TOOLS ARE TO BE USED ASSEMBLING THIS PRODUCT

1-2 people recommended for assembly



Wrenches  
(7/16", 1/2", 9/16")

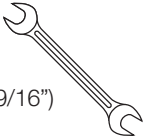

Socket and Ratchet  
(7/16", 1/2", 9/16")



Anti-seize or Bolt Lubricate



Allen Wrench  
(3/16")

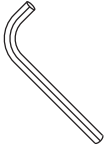

Rubber Mallet



## PARTS LIST

(NOT ACTUAL SIZE)

PACK

A



(x2) Rubber Gripper



(x2) 3/8" Black Oxide Bolt



(x2) Gripper Washer



(x2) 3/8" S/S Washer



(x2) Threaded Nut Plate



(x2) Tool Alignment Insert

# PARTS LIST

(NOT ACTUAL SIZE)



(x2) 3/8" x 2 x 1/2"  
S/S Bolt



(x4) 3/8" S/S  
Flat Washer



(x2) 3/8" S/S  
Nylock Nut



(x2) Square  
End Cap



(x2) 3/8" x 2 x 5/16"  
S/S Shoulder Bolt



(x2) 1/4" x 3"



(x4) 3/8" Nylon Washer



(x4) 1/4" S/S Flat Washer



(x2) 5/16" S/S Nylock Nut



(x2) 1/4" S/S Nylock Nut



(x4) 1/4" S/S  
Flat Washer



(x2) 1/4" S/S  
Acorn Nut



(x2) 1/4" x 2 1/2"  
S/S Bolt



(x2) Small Spacer



(x4) 3/8" S/S  
Washer



(x4) 1/2" S/S  
Washer



(x2) 1/2" S/S  
Nylock Nut



(x4) 3/8" S/S Nut

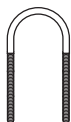

(x2) 3/8" U-Bracket 1

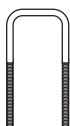

(x2) 3/8" Square  
U-Bracket



(x2) 1/2" x 3" Bolt

# PARTS LIST

(NOT ACTUAL SIZE)



(x2) 1/4" x 3 1/2"  
S/S Bolt



(x1) Large Spacer

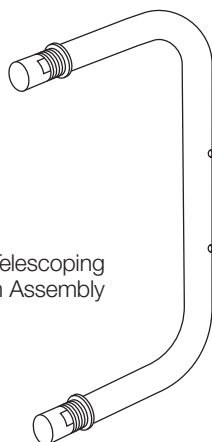

(x1) Telescoping  
Arm Assembly



(x1) Sign Plate



(x1) Clapper Plate

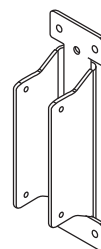

(x1) Mounting  
Bracket

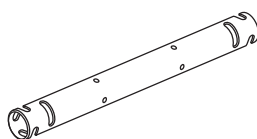

(x1) Mounting Pipe

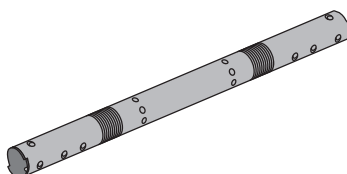

(x1) Malbec Tensioner

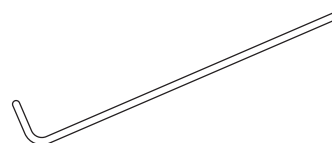

(x1) 5/16" Wrench

(x2) Long  
Receiver Pipe

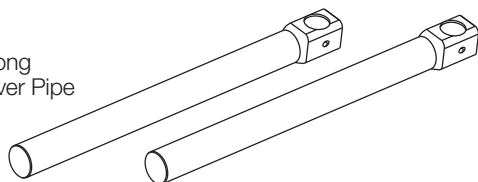

**Parallel mounting**  
28" – 36" openings  
**Perpendicular mounting**  
24 1/2" – 32 1/2" openings

(x2) Short  
Receiver Pipe

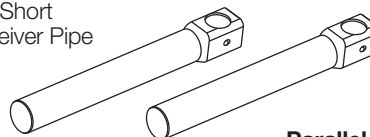

**Parallel mounting**  
20" – 28" openings  
**Perpendicular mounting**  
16 1/2" – 24 1/2" openings

# STEP 1

---

- Identify the gate location and take a measurement of the total opening area and determine mounting option (parallel or perpendicular).

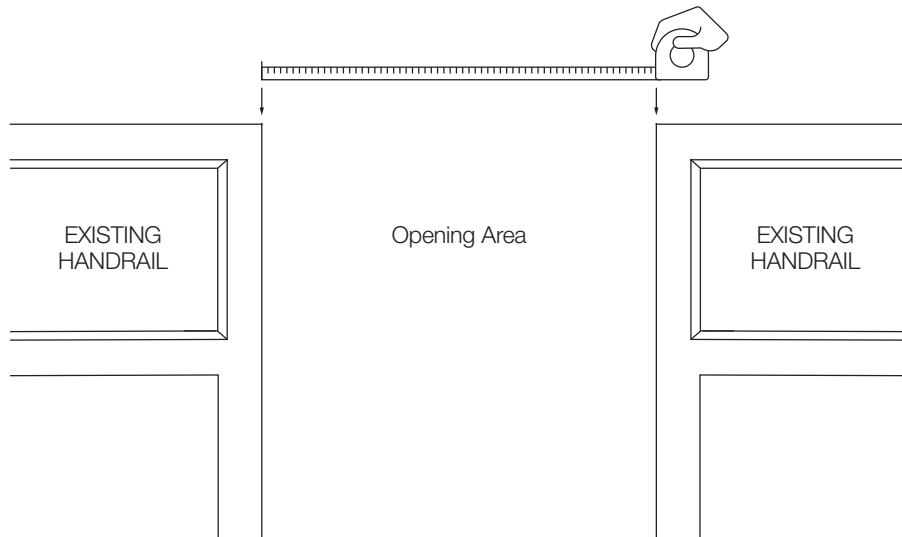

## Parallel Mounting Option

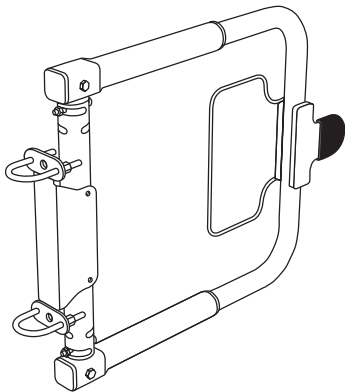

- For **Lower Range Openings** (20"-28") use Short Receiver Pipe.
- For **Upper Range Openings** (28"-36") use Long Receiver Pipe.
- Your final measurements for **Step 4** should be the total opening area, minus 3.5" inches.

## Perpendicular Mounting Option

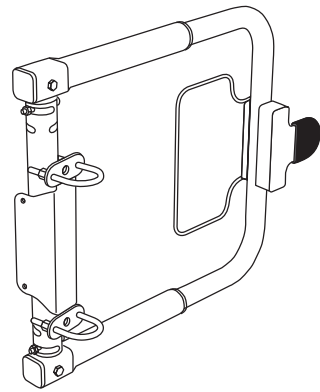

- For **Lower Range Openings** (16½"-24½") use Short Receiver Pipe.
- For **Upper Range Openings** (24½"-32½") use Long Receiver Pipe.
- Your final measurements for **Step 4** should be the same as the total opening area.

## STEP 2

- Assemble bolt, flat washer, gripper washer, and rubber gripper together as shown.
- Be sure insert threaded nut plate tab is centered and positioned in slots on telescoping arm. Hold tab in place with hand while inserting bolt gripper assembly into arm with other hand.
- Hand tighten until bolt gripper assembly is secure. Repeat for both ends of telescoping arm.

**NOTE:** Balance of **Pack A** parts will be used in **Step 4**

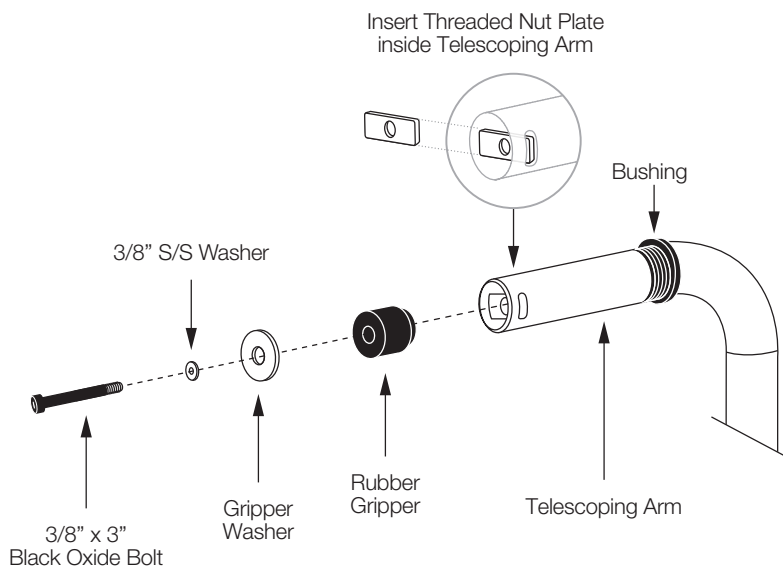

Side View

**PACK A**

**Hardware needed:**

- (2) 3/8" x 3" Black oxide allen head bolt
- (2) 3/8" S/S Flat washer
- (2) Gripper washer
- (2) Rubber gripper

## STEP 3

- Insert tensioner into mounting pipe.

**NOTE:** Tensioner may already be located in the mounting pipe from manufacturer.

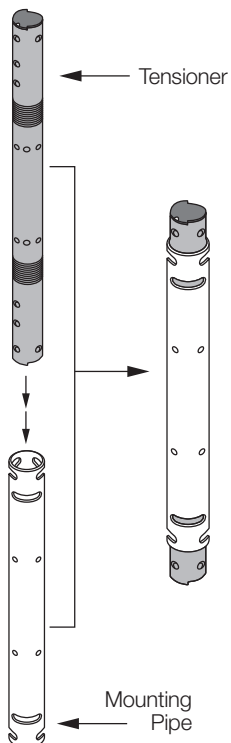

- After selecting proper receiver pipe size, slide appropriate pipe, including each bushing 2, onto each end of tensioner as shown. Do not bolt until **Step 6**.

**NOTE:** Refer to **Step 1** for receiver pipe sizing dimensions.

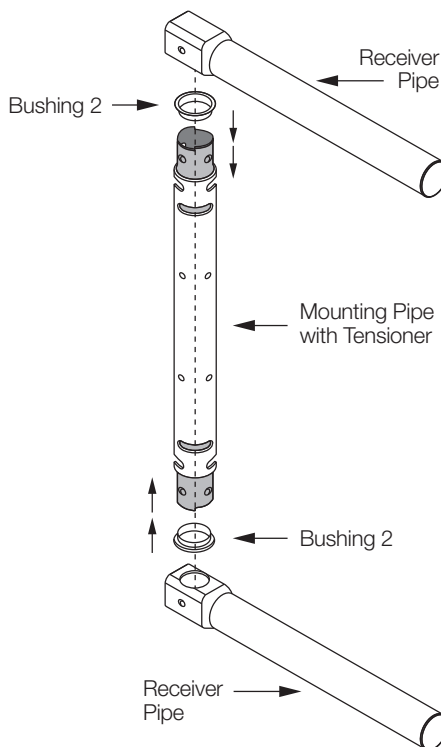

**NOTE:** Be sure correct tensioner slots for your use are in position before beginning the next step.

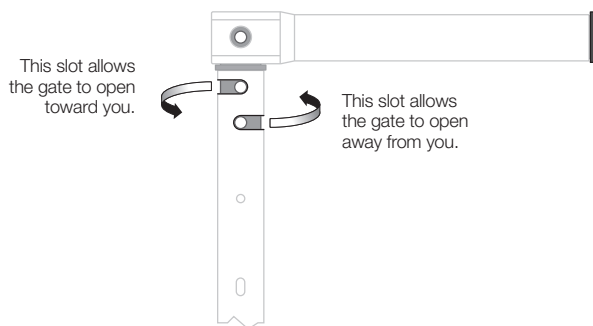

Choosing the correct Receiver Pipe



**Parallel Mounting** (28"-36") openings

**Perpendicular Mounting** (24½"-32½") openings



**Parallel Mounting** (20"-28") openings

**Perpendicular Mounting** (16½"-24½") openings



## STEP 4

- Slide tool alignment insert from **Pack A** into the receiver pipe opening.  
**Be sure flared side goes in towards tensioner.** (see Pic 1)
- Slide telescoping arm into each end of receiver pipes as shown.
- Using a tape measure, position telescoping arm according to desired gate size determined from **Step 1**. Measuring from the outside edge to the inside edge of the gate. (see Pic 2)
- Slide 1 bushing onto each receiver pipe. Using the large spacer from **Pack F**, lay curved edge against the Telescoping Arm Assembly and tap bushing securely into position within receiver pipe.
- Insert supplied allen wrench through hole in tensioner at end of receiver pipe and position on bolt.
- Hand tighten until telescoping arm is firmly secure. Repeat for the other side.

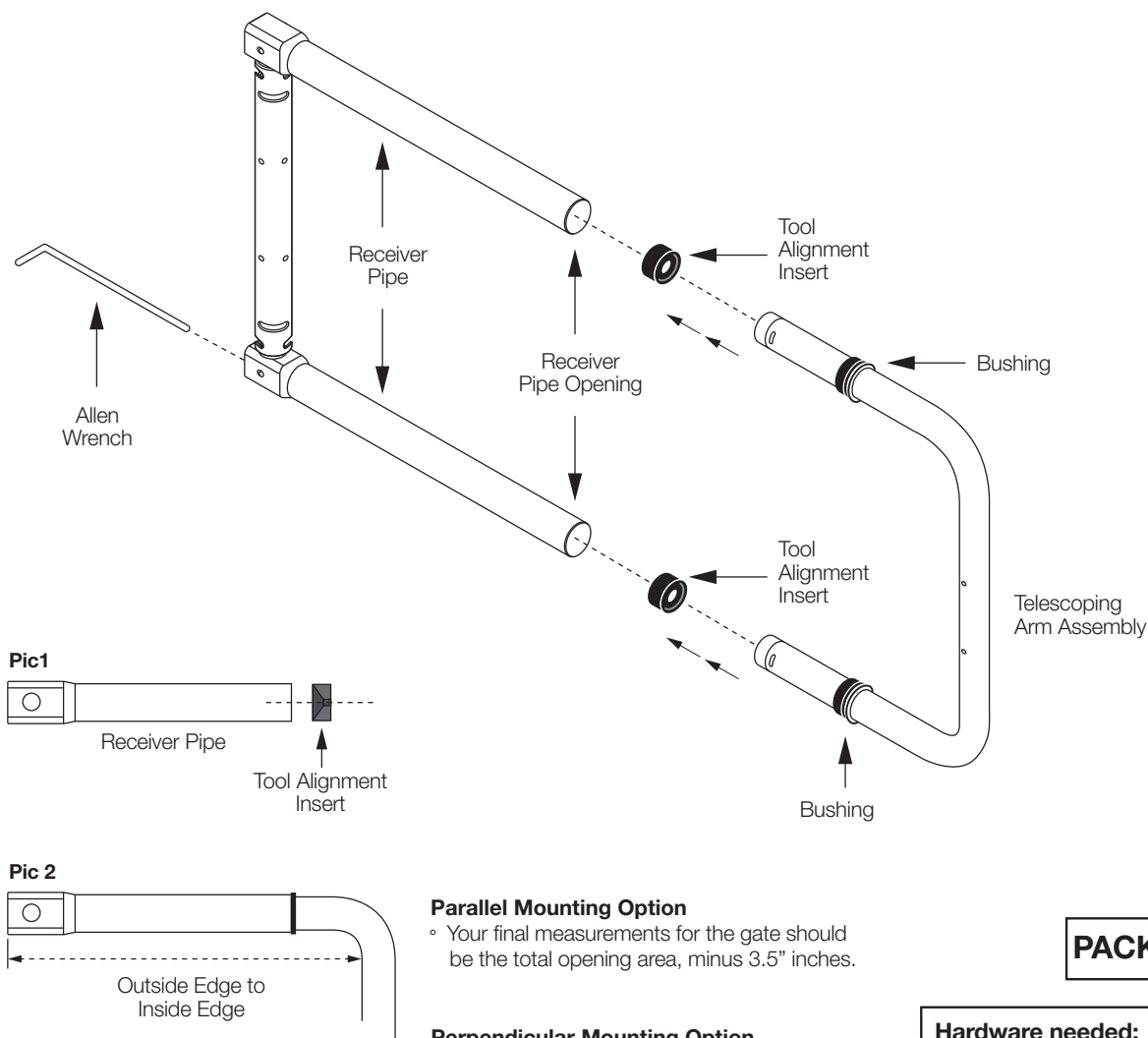

### Parallel Mounting Option

- Your final measurements for the gate should be the total opening area, minus 3.5" inches.

### Perpendicular Mounting Option

- Your final measurements for the gate should be the same as the total opening area.

**PACK A**

### Hardware needed:

- (1) Allen Wrench
- (2) Tool Alignment Insert

## STEP 5

- Now that telescoping arm is in place, bolt receiver pipes to tensioner with supplied hardware as shown. *\*Add a small amount of anti-seize or bolt lubricant on each 3/8" x 2 1/2" bolt during this step.*
- Push square end cap into end of each receiver pipe as shown.
- If the bolt holes do not line up, refer back to **STEP 3** to line up the holes for the Malbec Tensioner.

**NOTE:** See correct tensioner position in illustration below before beginning this step.

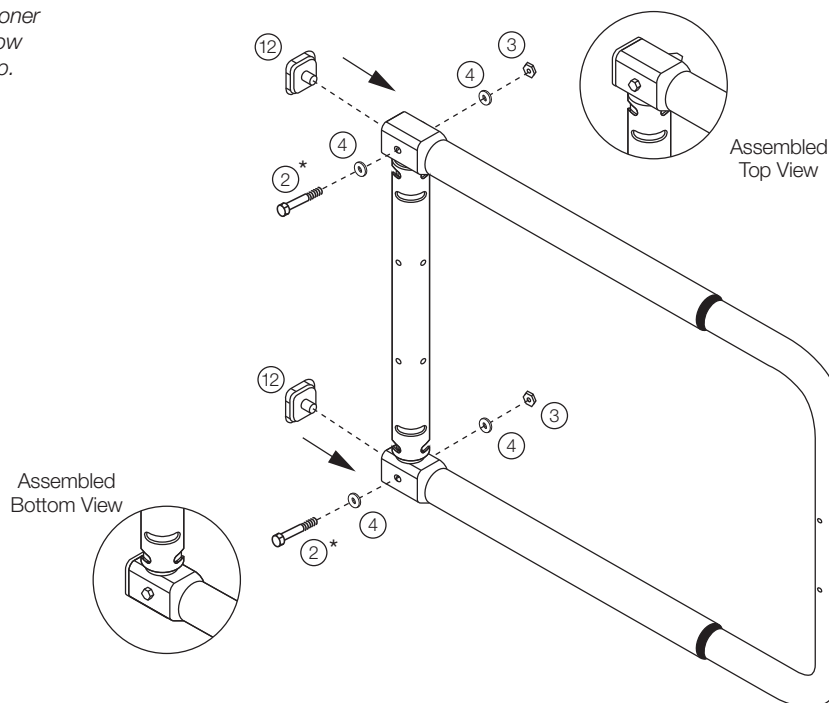

### Correct Tensioner Position

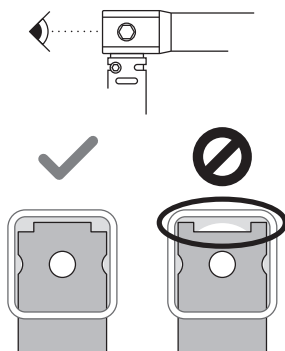

#### Highly Important Note:

During assembly of the tensioner spring into the receiver tube, maintain orientation of the notches on the end of the spring towards the corners of the squares portion.

**PACK B**

#### Hardware needed:

- (2) #2 - 3/8" x 2 1/2" S/S Bolt
- (2) #3 - 3/8" S/S Nylock Nut
- (4) #4 - 3/8" S/S Flat Washer
- (2) #12 - Square End Cap

**PACK E**

#### \*Hardware needed:

- (2) #1 - 1/2" x 3" S/S Bolt
- (4) #4 - 1/2" S/S Washer
- (4) #5 - 1/2" S/S Nut

## STEP 6

Parallel Mounting Option

If Perpendicular Mounting proceed to

STEP 10

### TENSION SET-UP

- Locate the mounting holes above and below rectangular notch in mounting pipe.
- Rotate the mounting pipe in the opposite direction 90 degrees of the desired gate swing. Locating the 1st or 2nd hole in the tensioner.
- See swing direction example for parallel mount here.

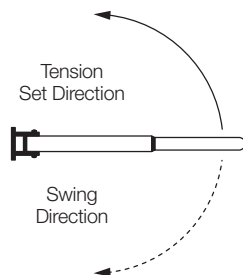

**NOTE:**  
Notch is always  
perpendicular  
to gate rails

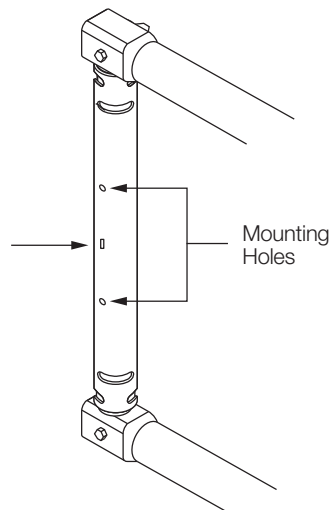

- Insert 1/4" bolts with a flat washer through the mounting bracket, mounting pipe & tensioner.
- Install flat washer and lock nut on the opposite side.  
\*Applying anti-seize lubricant to each bolt.

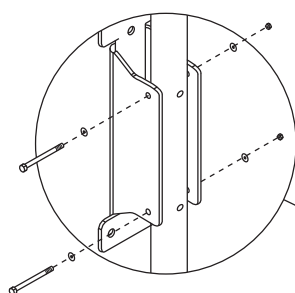

Close up view  
Mounting Bracket with  
Mounting Pipe in place

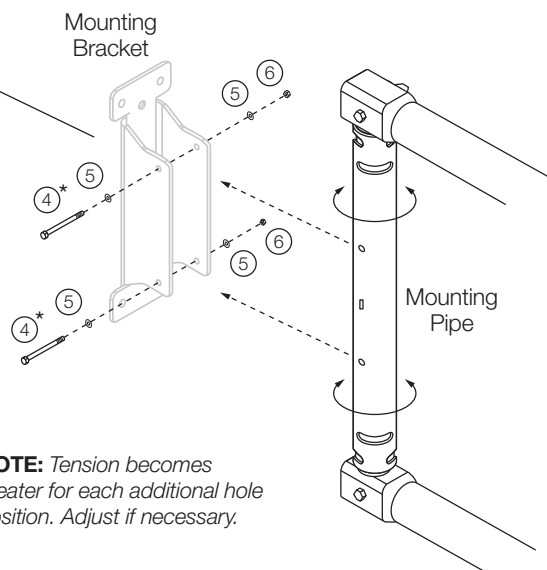

**NOTE:** Tension becomes  
greater for each additional hole  
position. Adjust if necessary.

**PACK C**

#### Hardware needed:

- (2) #4 - 1/4" x 3" S/S Bolt
- (4) #5 - 1/4" SS Flat Washer
- (2) #6 - 1/4" S/S Nylock Nut

## STEP 7

### Parallel Mounting Option

#### POSITIVE STOP SET-UP

- Rotate mounting bracket back square with opening (the desired closed position), to expose the tensioner hole through the mounting pipe slot. Insert the shoulder bolt. This will hold the Malbec Tensioner from springing back.
- Repeat this on the opposite end of the mounting pipe and tighten each nut, using 3/16" allen wrench, so that the washer can still move slightly.

#### Parallel Mounting Option

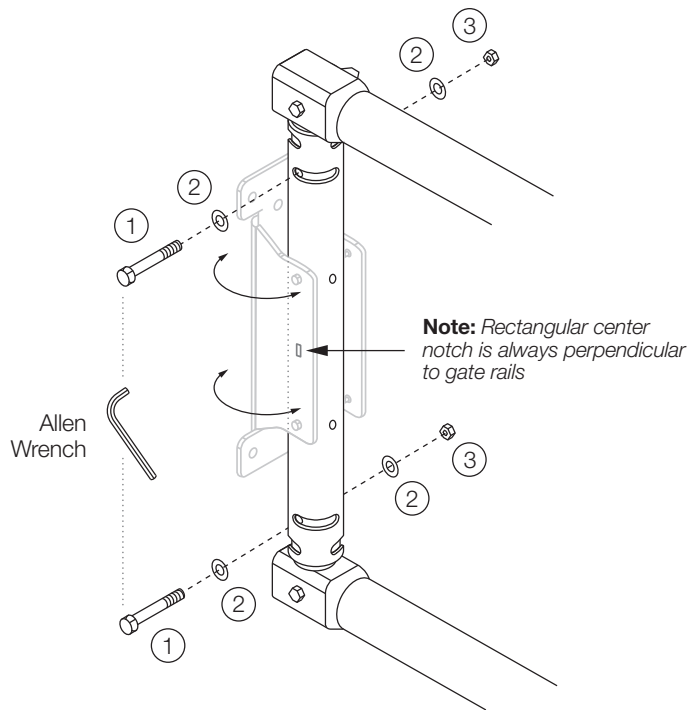

**NOTE:** While gate is in "tension" position, one hole in tensioner is visible through one of the top and bottom slots in mounting pipe. When rotating gate back to "closed" position, holes will be visible in the opposite slots in the mounting pipe, which are the correct holes for bolting to complete tension set up.

**NOTE:** Be sure correct tensioner slots for your use are in position before beginning the next step.

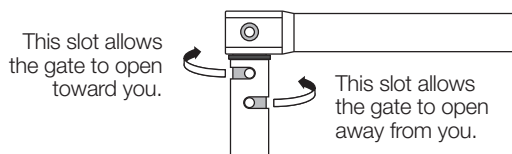

**PACK C**

#### Hardware needed:

- (2) #1 - 3/8" x 2 x 5/16" S/S Shoulder Bolt
- (4) #2 - 3/8" Nylon Washer
- (2) #3 - 5/16" S/S Nylock Nut

## STEP 8

### Parallel Mounting Option

#### PARALLEL MOUNT

- Mount clapper, spacers, and sign plate as shown in diagram using supplied bolts, nuts, and washers.

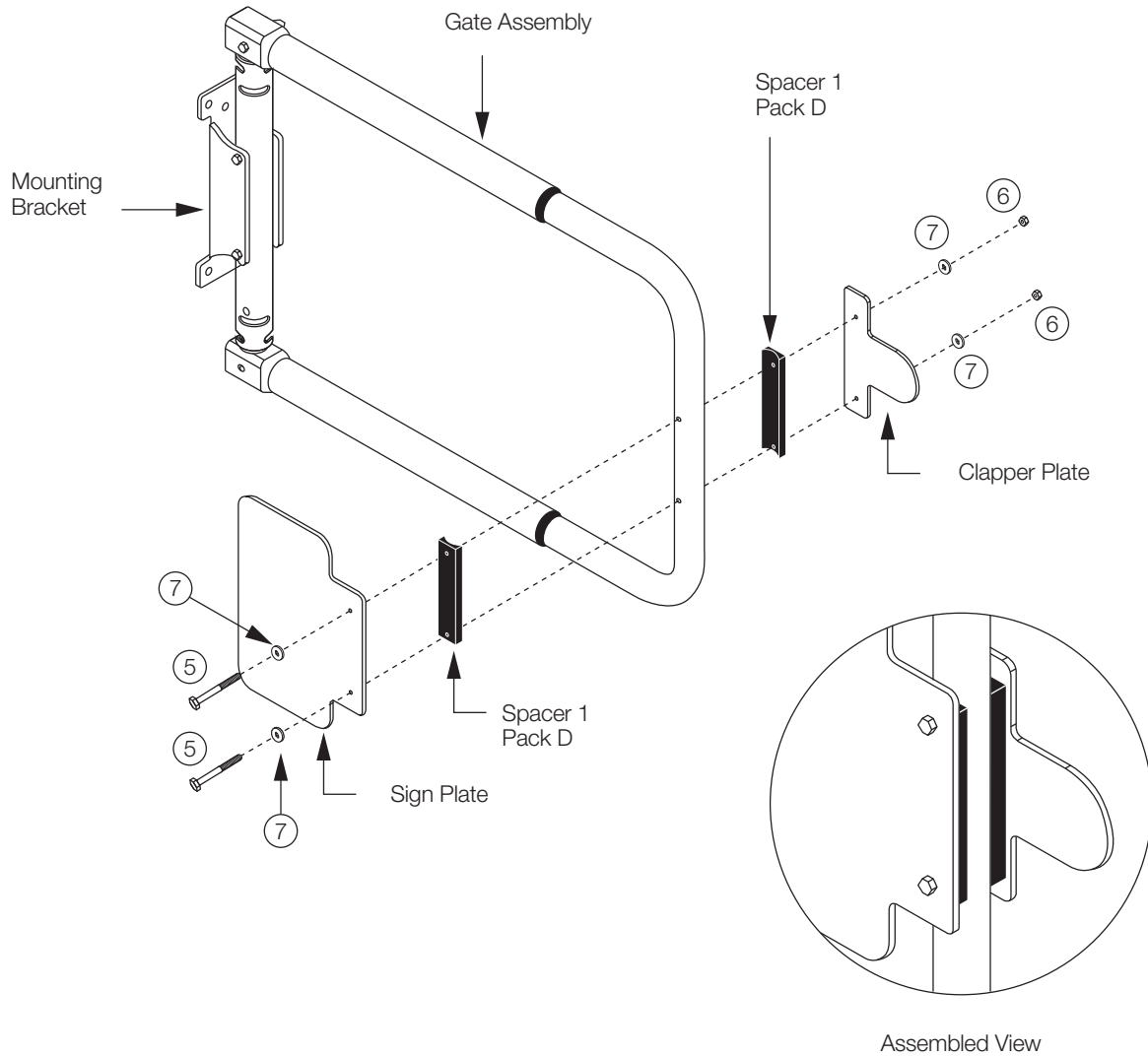

**PACK D**

#### Hardware needed:

- (2) #5 - 1/4" x 2 1/2" S/S Bolt
- (2) #6 - 1/4" S/S Acorn Nut
- (2) #7 - 1/4" S/S Flat Washer

## STEP 9

### Mounting Options

#### Parallel Mounting Option

#### IMPORTANT FOR PARALLEL OPTION

Be sure Steps 6-8 have been completed before beginning this mounting step.

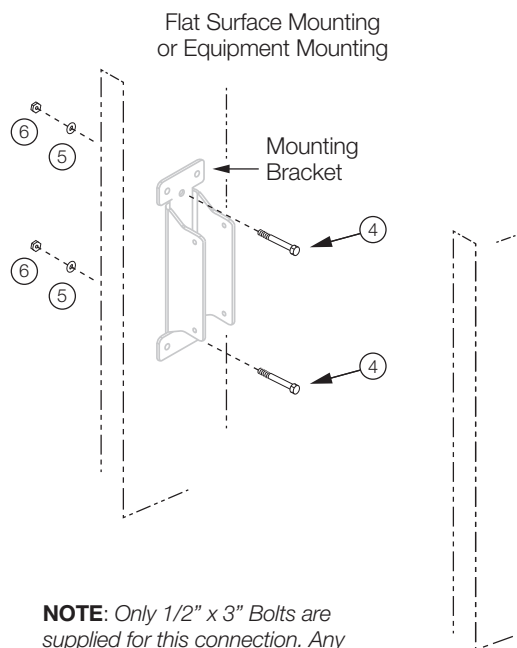
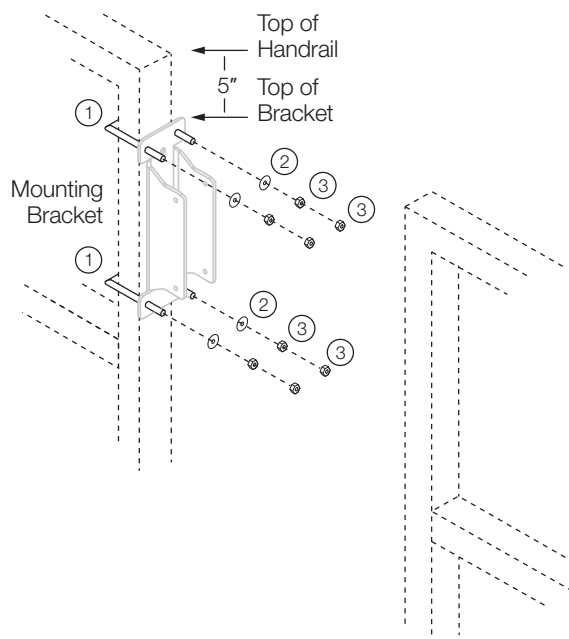

**NOTE:** Only 1/2" x 3" Bolts are supplied for this connection. Any other size needed will not be supplied.

#### Perpendicular Mounting Option

#### IMPORTANT FOR PERPENDICULAR OPTION

Be sure Steps 10-12 have been completed before beginning this mounting step.

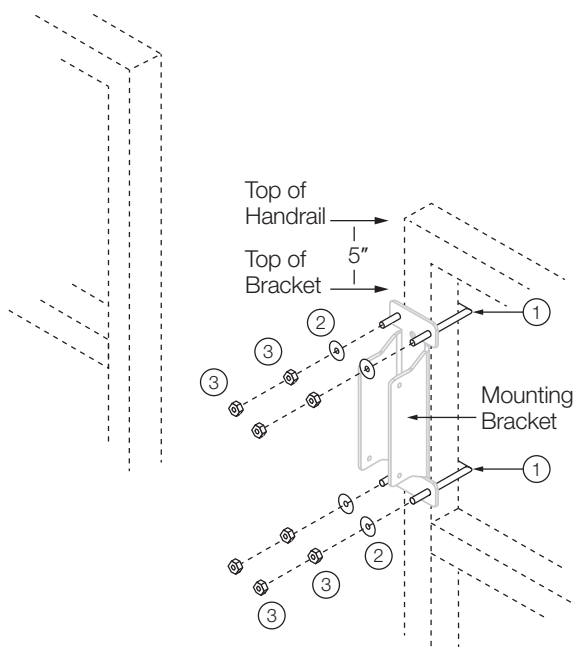

**PACK E**

#### Hardware needed:

- (2) #1 - U-Bracket
- (4) #2 - 3/8" S/S Flat Washer
- (4) #3 - 3/8" S/S Nut
- (2) #4 - 3/8" x 2 1/2" S/S Bolt
- (4) #5 - 3/8" S/S Flat Washer
- (2) #6 - 3/8" S/S Nylock Nut

# STEP 10

## Perpendicular Mounting Option

### TENSION SET-UP

- Locate the mounting holes above and below rectangular notch in mounting pipe.
- Rotate the mounting pipe in the opposite direction 90 degrees of the desired gate swing. Locating the 1st or 2nd hole in the tensioner.
- See swing direction example for parallel mount here.

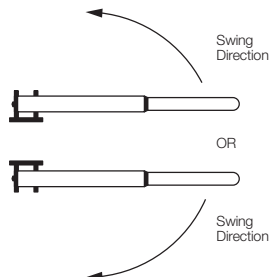

#### NOTE:

*Notch is always perpendicular to gate rails*

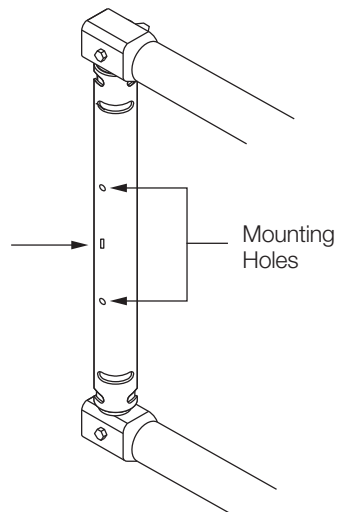

- Insert 1/4" bolts with a flat washer through the mounting bracket, mounting pipe & tensioner.
  - Install flat washer and lock nut on the opposite side.
- \*Applying anti-seize lubricant to each bolt.

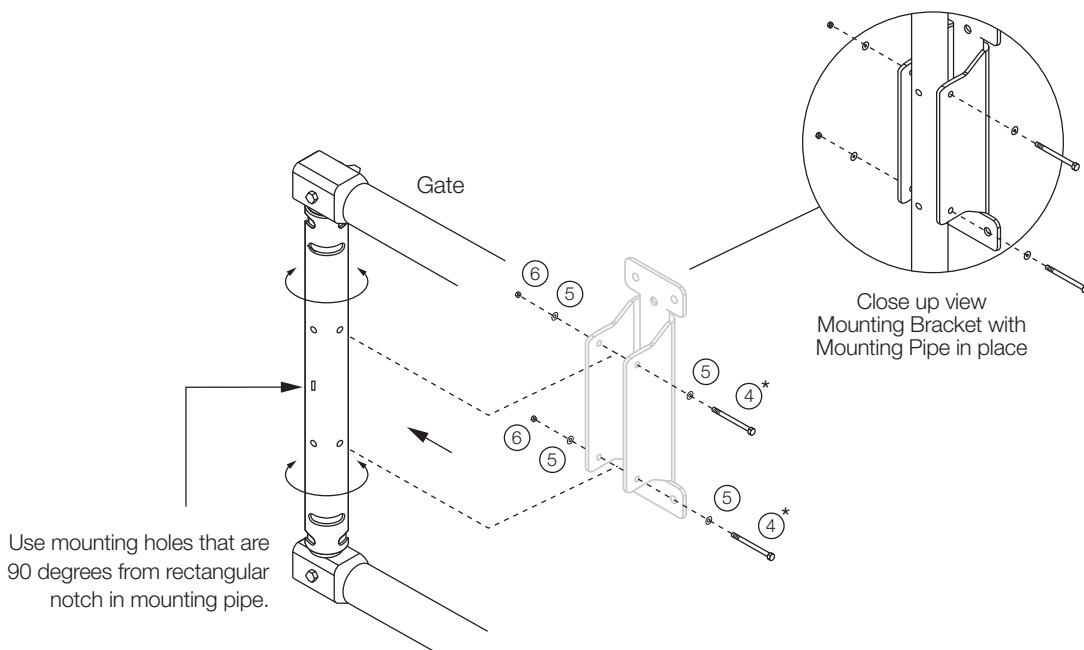

**PACK C**

#### Hardware needed:

- (2) #4 - 1/4" x 3" S/S Bolt
- (4) #5 - 1/4" SS Flat Washer
- (2) #6 - 1/4" S/S Nylock Nut

## STEP 11

### Perpendicular Mounting Option

#### POSITIVE STOP SET-UP

- Rotate mounting bracket back square with opening (the desired closed position), to expose the tensioner hole through the mounting pipe slot. Insert the shoulder bolt. This will hold the Malbec Tensioner from springing back.
- Repeat this on the opposite end of the mounting pipe and tighten each nut, using 3/16" allen wrench, so that the washer can still move slightly.

### Perpendicular Mounting Option

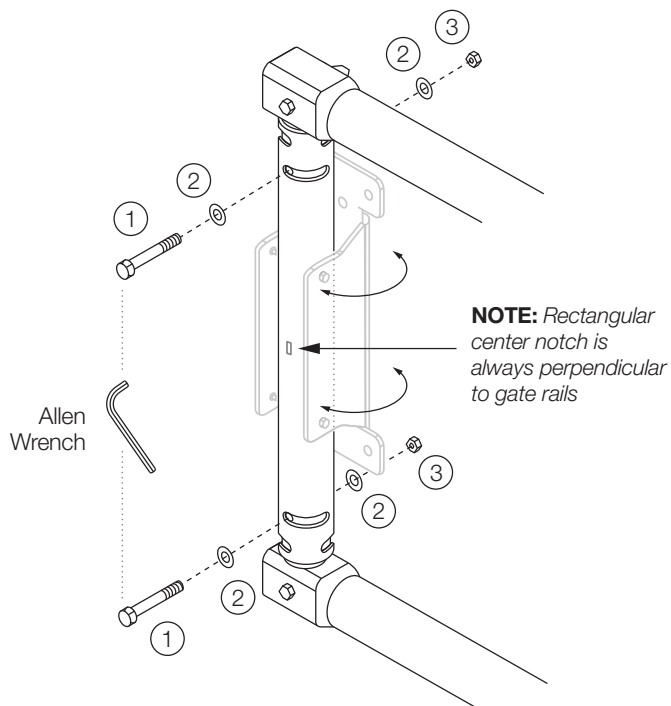

**NOTE:** While gate is in "tension" position, one hole in tensioner is visible through one of the top and bottom slots in mounting pipe. When rotating gate back to "closed" position, holes will be visible in the opposite slots in the mounting pipe, which are the correct holes for bolting to complete tension set up.

**NOTE:** Be sure correct tensioner slots for your use are in position before beginning the next step.

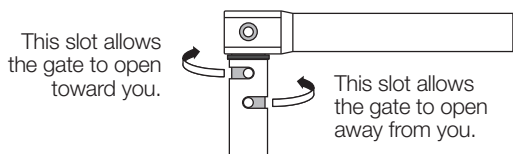

**PACK C**

#### Hardware needed:

- (2) #1 - 3/8" x 2 x 5/16" S/S Shoulder Bolt
- (4) #2 - 3/8" Nylon Washer
- (2) #3 - 5/16" S/S Nylock Nut

## STEP 12

### Perpendicular Mounting Option

#### PERPENDICULAR MOUNT

- Mount clapper, UHMW spacers, and sign plate as shown in diagram using supplied bolts, nuts, and washers.

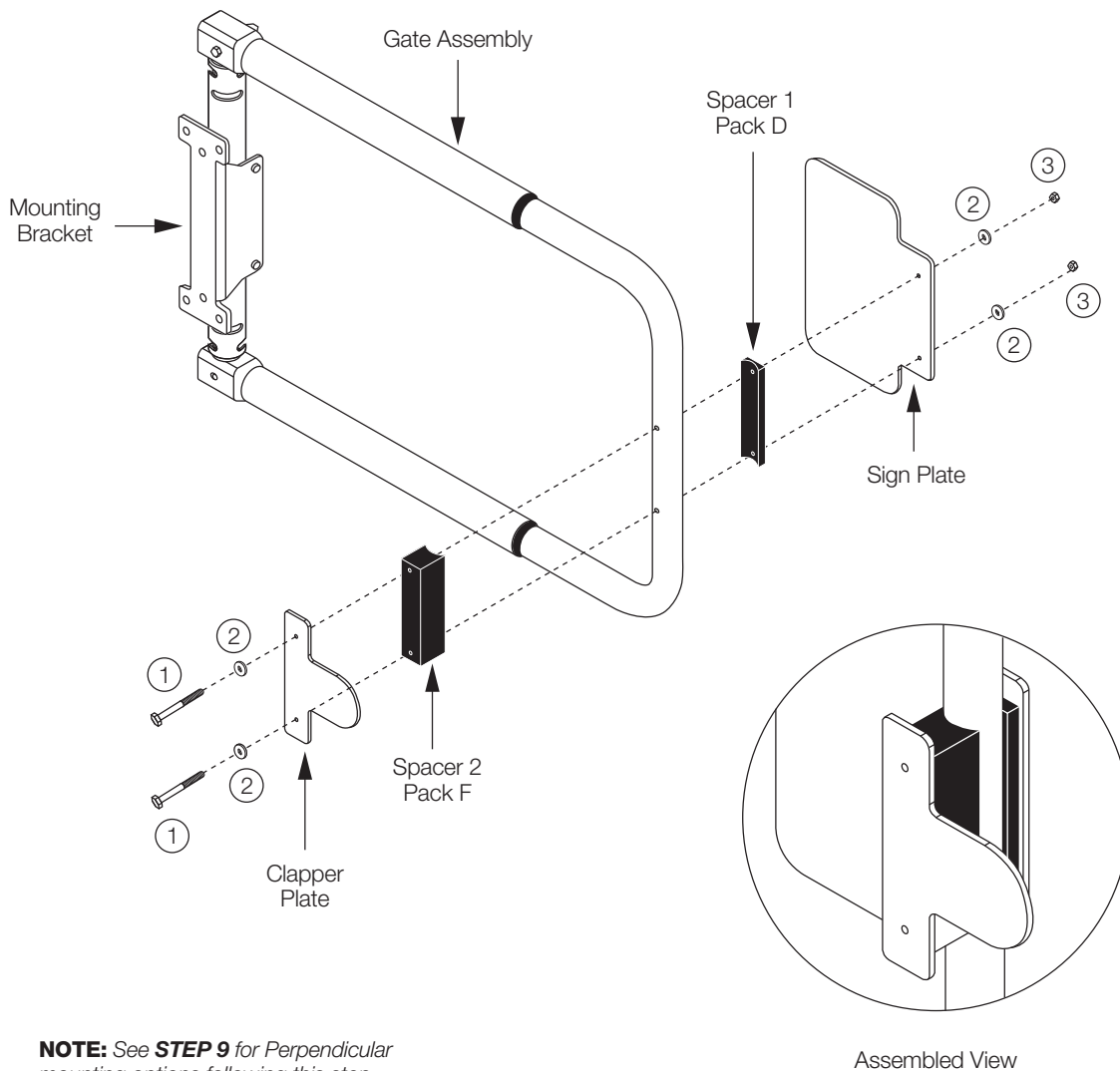

**NOTE:** See **STEP 9** for Perpendicular mounting options following this step.

**PACK D | F**

#### Hardware needed:

- (2) #1 - 1/4" x 3 1/2" S/S Bolt
- (2) #2 - 1/4" S/S Flat Washer
- (2) #3 - 1/4" S/S Acorn Nut

#### Hardware needed:

- (2) #1 - 1/4" x 2 1/2" S/S Bolt
- (2) #2 - 1/4" S/S Flat Washer
- (2) #3 - 1/4" S/S Acorn Nut